



Weddings
AT THE EDGEWATER



Courtney Boulden Photography

FOREVER

Begins at the Edge

Whether it's your first special day or the many who share in the growing popularity of a renewal of wedding vows, The Edgewater's spectacular waterfront wedding location offers the ultimate in Seattle weddings. Say "I do," celebrate, and begin your new journey together.



WEDDING

Packages

Start your life together, with a dream wedding at Seattle's only waterfront hotel. You'll be immersed in the warmth and wonder of the classic Pacific Northwest experience, right on Pier 67 at the city's dynamic doorstep. The stage is set and you're the star, with Elliott Bay and Olympic Mountain views as your backdrop. From a festive bridal shower to a dramatic rehearsal dinner and breathtaking post-wedding brunch, let the celebration and your new life begin with us! Tell us about your ideal wedding dreams, and our wedding experts and professional catering services team will follow through. We pay the utmost attention to every detail to make sure your wedding dreams come true.



WEDDING

Venues

OLYMPIC BALLROOM

The Olympic Ballroom is our largest event facility. The floor-to-ceiling window wall provides an unobstructed panoramic vista of Elliott Bay, the Olympic Mountains and the islands of Puget Sound. The spaciousness of this room allows for a wide variety of configurations. Fir beams join at the center of the ballroom's 16 foot ceiling creating a dramatic space for a couple's first dance.



TERRACE

Dramatic eight-foot French doors that open onto our outdoor terrace accent the Terrace Room. The deck allows guests sweeping views of the Seattle skyline. Three large mirrors, a stone fireplace and two Lorraine Versailles crystal chandeliers make the versatile Terrace Room an elegant space in which to relax over cocktails or host a comfortable dinner. The Terrace Room is often used in conjunction with the Olympic Ballroom to provide access to the great outdoors; it is also the perfect setting for smaller events. Several different seating arrangements can accommodate up to 55 guests.

ALKI ROOM

The Alki Room boasts four bay windows, a built-in slate-topped buffet, and can host up to 60 guests with small dance floor. This room is perfect for mid-size events, dinners, or cocktail parties. A connecting door to the Winslow Room offers additional space for buffet dining.



TERRACE

FOREST

If you're searching for an elegant restaurant atmosphere with the privacy of your own room, this private dining room can accommodate up to 30 people for dinner or 40 guests for a cocktail party. Sliding glass doors open onto an outside deck over Elliott Bay. A gas fireplace and northwest décor perfectly complement this intimate event space.

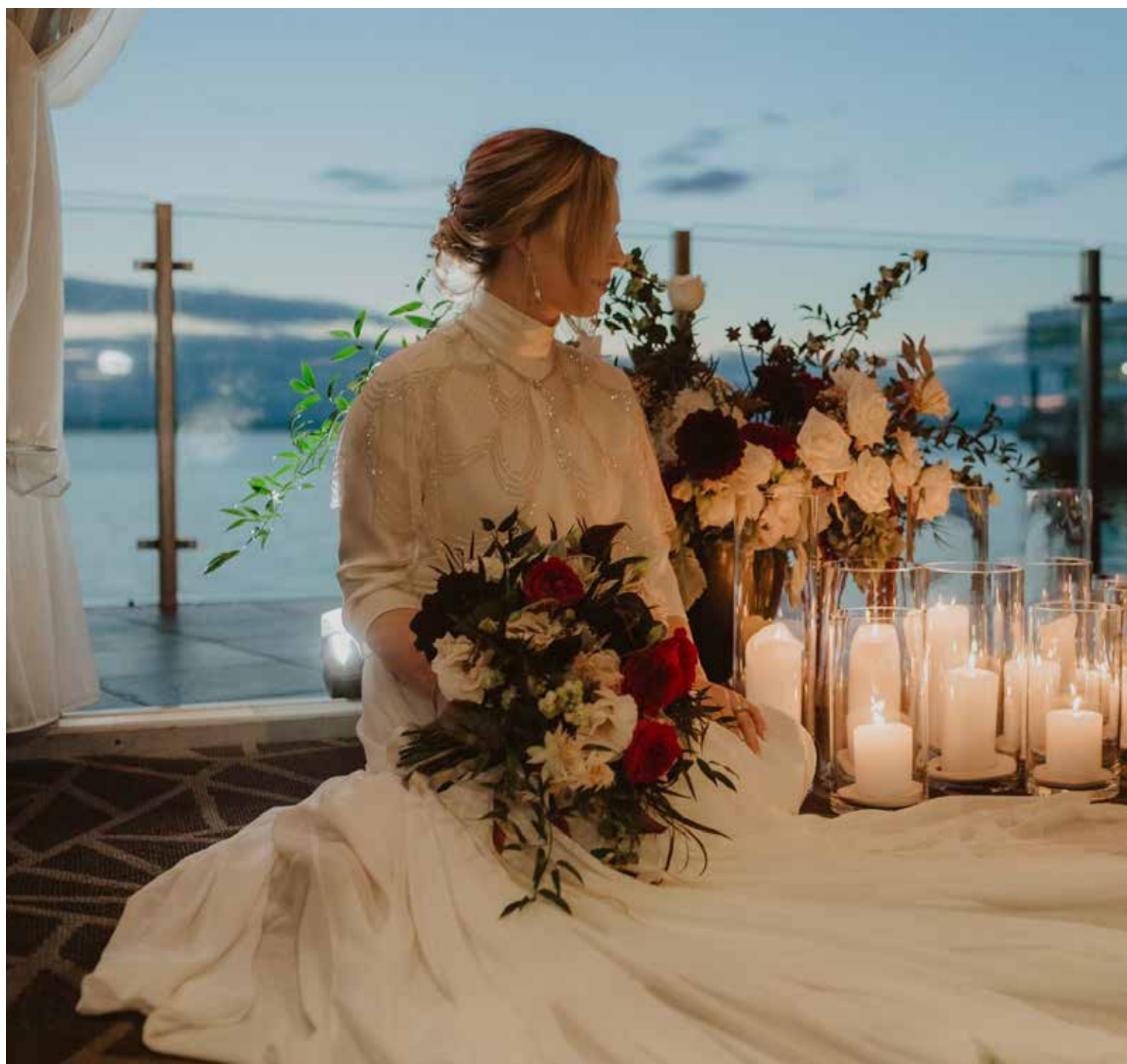

Olympic Ballroom & Terrace

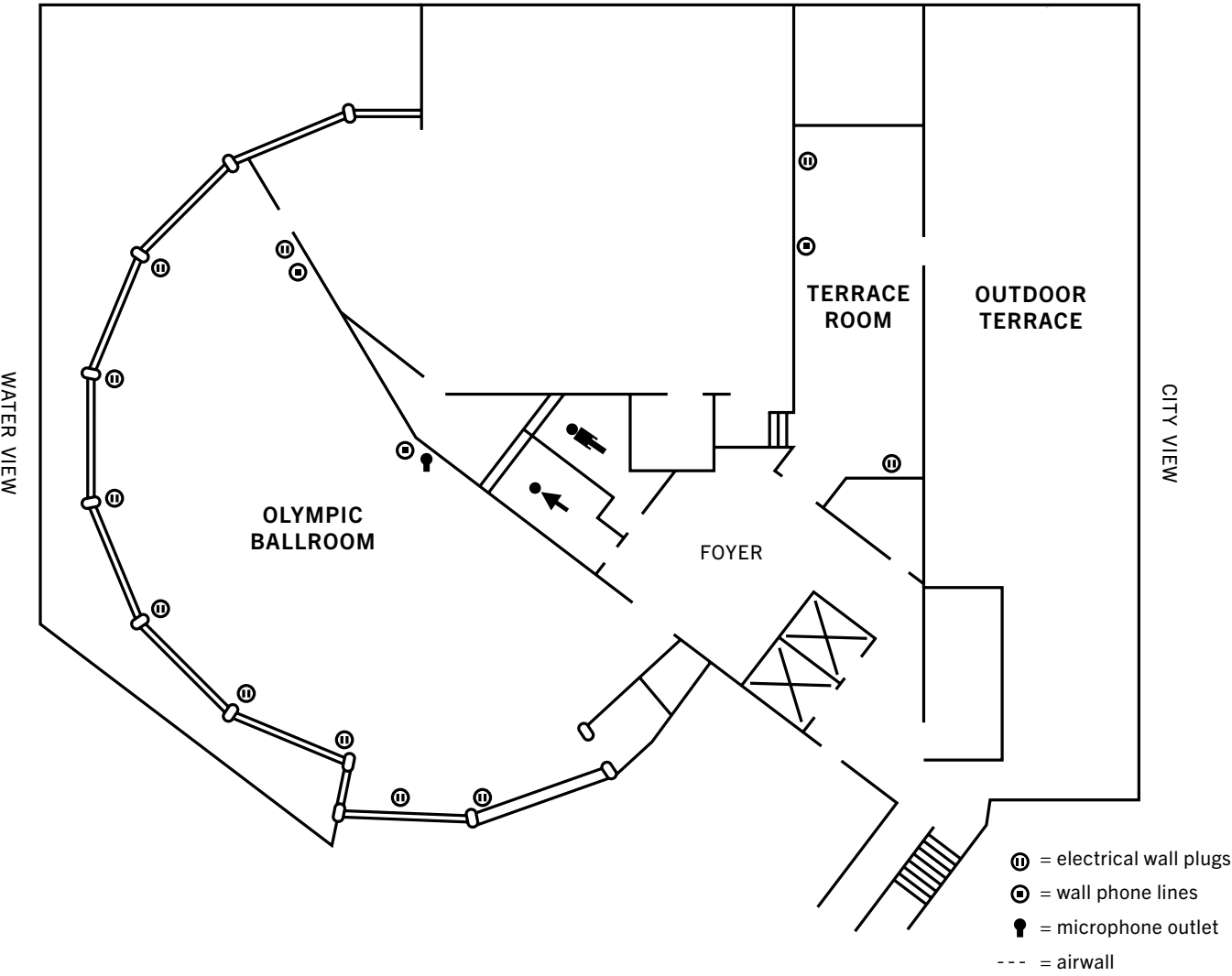

WEDDING VENUES

	<i>Dimensions</i>	<i>Approx. Sq. Ft.</i>	<i>Banquet</i>	<i>Reception</i>
OLYMPIC BALLROOM	62' x 91'	2,572	200	250
TERRACE ROOM	42' x 16'	720	30	55
OUTDOOR TERRACE & DECK	23' x 51'	960	70	110

Orcas, Winslow, Alki, & Elliott

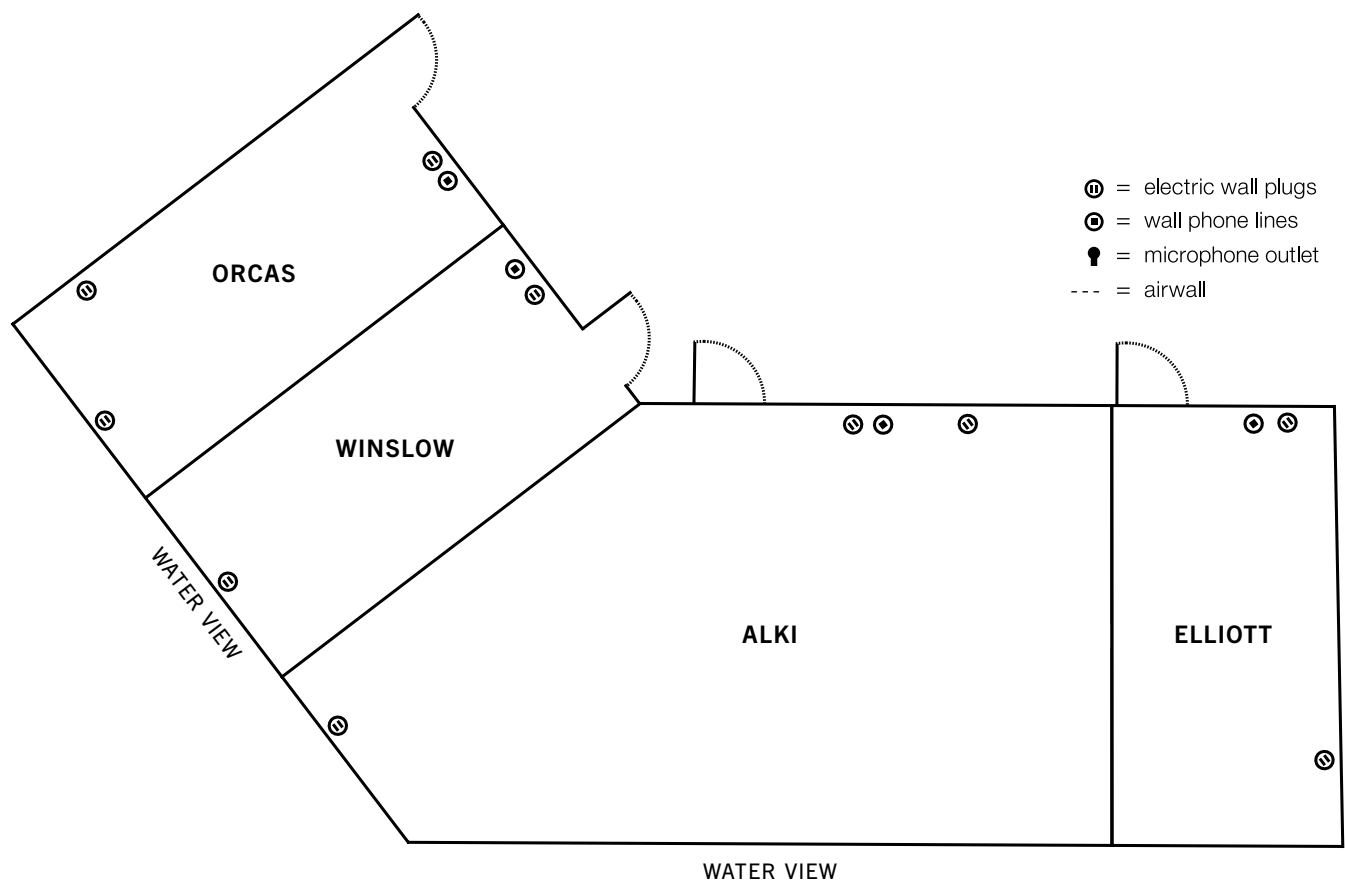

WEDDING VENUES

	<i>Dimensions</i>	<i>Approx. Sq. Ft.</i>	<i>Banquet</i>	<i>Reception</i>
ORCAS ROOM	27' x 12'	350	24	35
WINSLOW ROOM	27' x 12'	350	24	35
ALKI ROOM	26' x 50'	1,111	60	80
ELLIOTT ROOM	27' x 12'	350	24	35

Forest

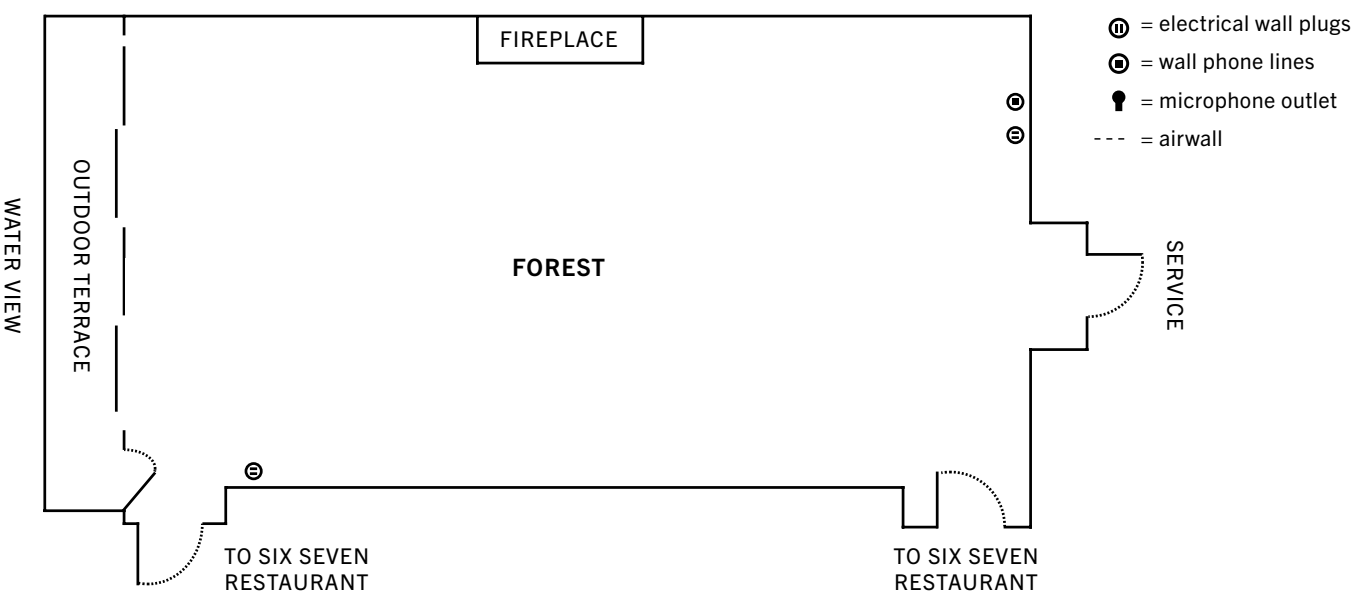

WEDDING VENUES

	<i>Dimensions</i>	<i>Approx. Sq. Ft.</i>	<i>Banquet</i>	<i>Reception</i>
FOREST ROOM	19' x 32'	541	30	40



THE EDGEWATER

A NOBLE HOUSE HOTEL

EDGEWATERHOTEL.COM | 206.792.5959 | SEATTLE, WA

Something Minted Photography